

Waldfeststellungen

M 1:500
6. Mai 2024

Waldgrenzen von der Abteilung Wald und Naturgefahren geprüft:



Öffentliche Auflage:

Vom Amt für Raum und Wald erlassen:

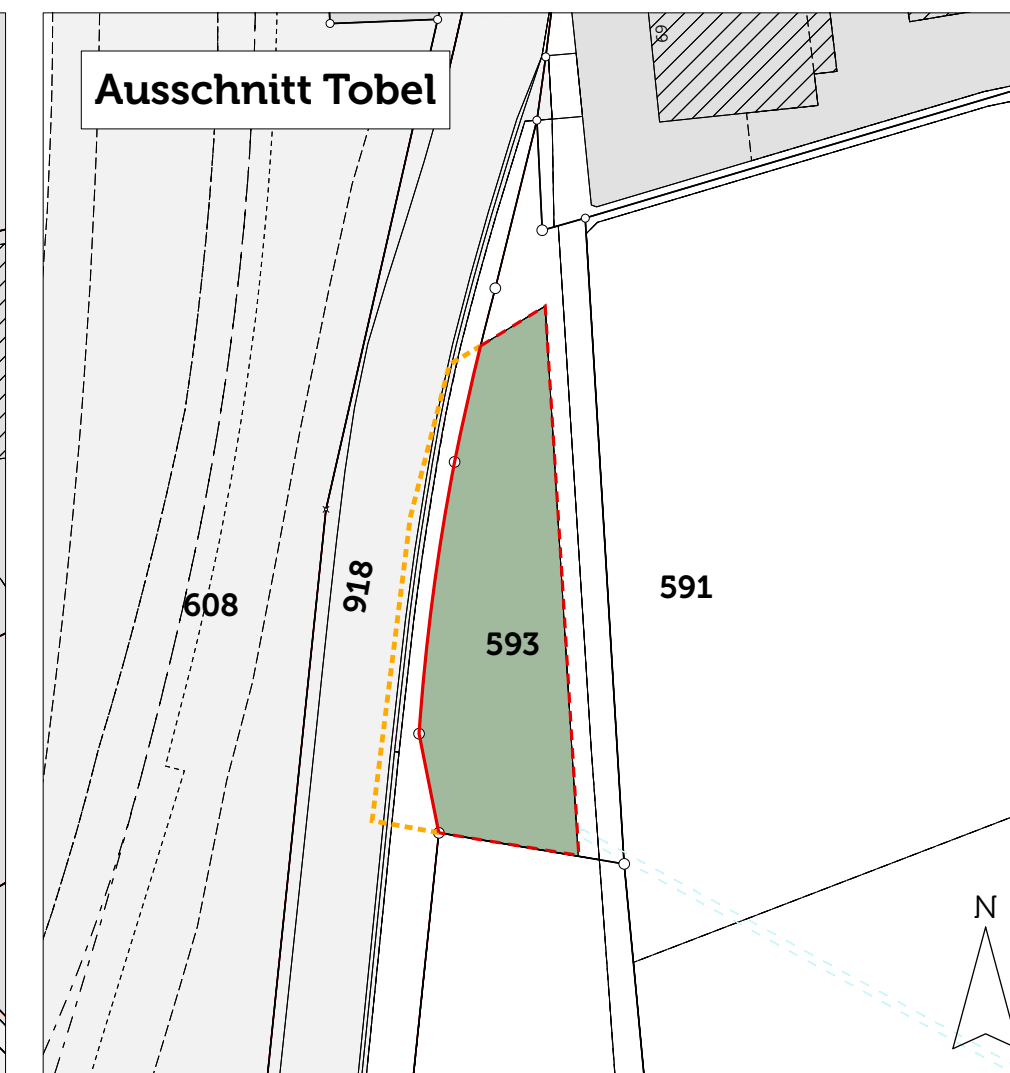
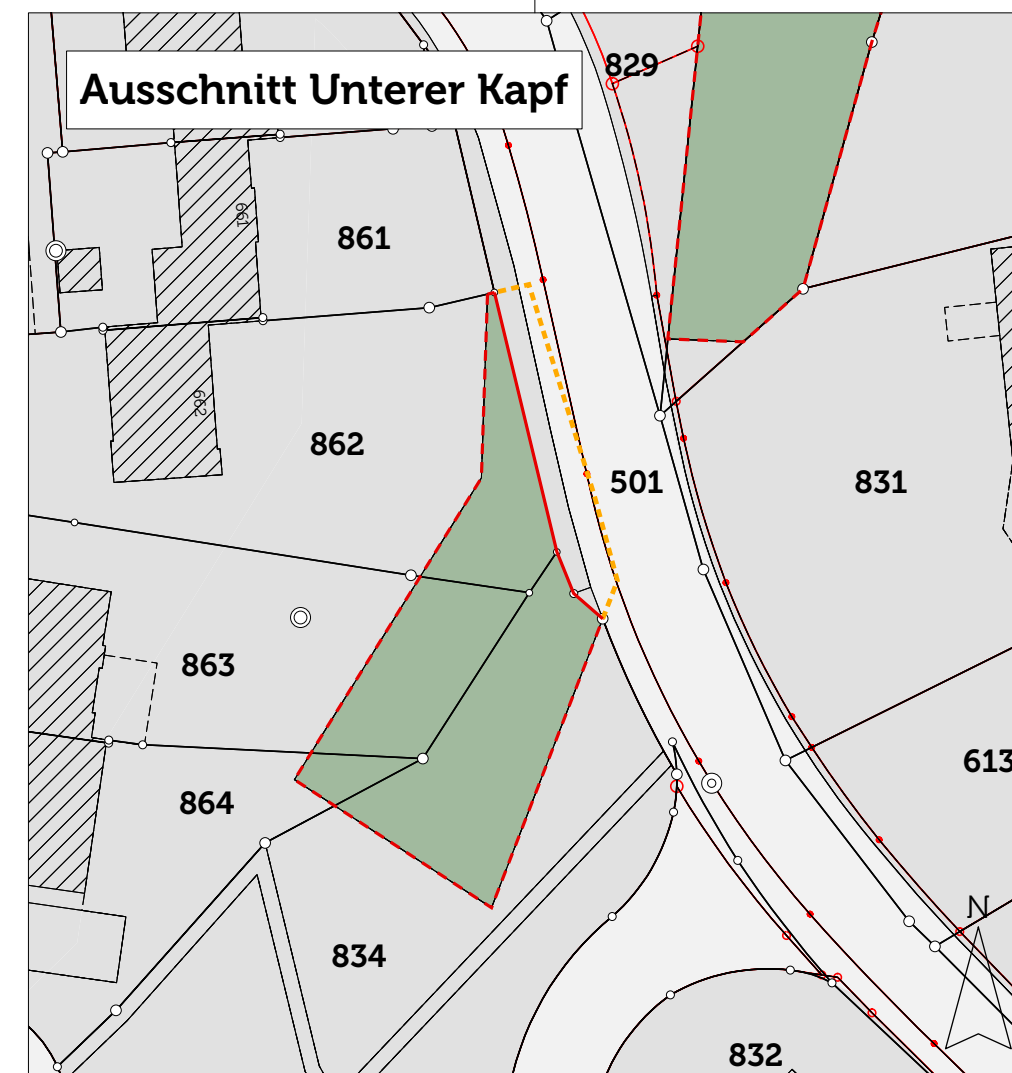
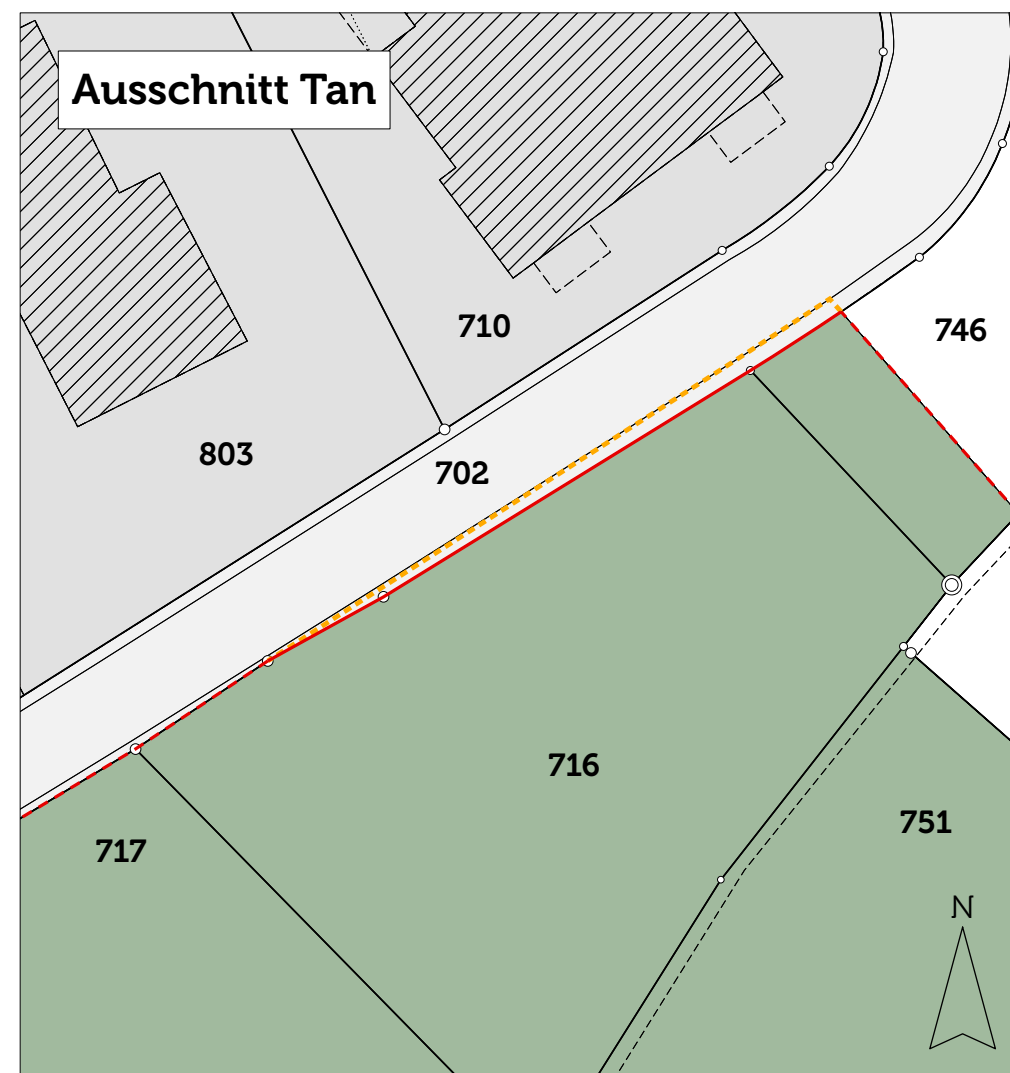



Beat Fritsche, Oberförster



Festlegungen

-  Waldgrenze, neu
-  Waldgrenze, aufzuheben

Hinweise

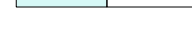
-  Wald
-  Waldgrenze vom Amt für Raum und Wald erlassen
-  Baugebiet
-  Verkehrsfläche
-  Gewässer, offen | eingedolt